



# HF1 Hydraulic Force Series™ Utility Winch Specifications

Specification/Feature	HF1 Utility Winch
Motor Type	Orbital Motor
Gearing	Single-State Planetary Gearbox
Gear Ratio	5.23:1
First Layer Lifting Capacity (lbs)	1,100 lbs
Top Layer Lifting Capacity (lbs)	840 lbs
First Layer Line Speed (fpm)	164 fpm @ 7.7 GPM
Top Layer Line Speed (fpm)	214 fpm @ 7.7 GPM
Rope Storage Capacity (ft)	135ft (5/16" wire rope)
Working Rope Capacity (ft)	97 ft (5/16" wire rope)
Operating Pressure (psi)	2250 psi (max)
Flow Rate (gpm)	7.7 gpm (max)
Shipping Weight (lbs)	75 lbs*
Drum Length (in)	5.79"
Brakes	Disc + counterbalance valve
Throttle Type	Manual proportional
Min Design Temperature	-10°C (14°F)
D/d Ratio	20:1 (5/16" wire rope)
Cable Anchor Design	Drum Wedge
Control Options	Local Lever Standard Option for Remote Lever
Drum Guard	Option
Cable Tensioner (Press Roller)	Option
Other Features of Note	Electric over hydraulic control valve configured for wireless controller

\*Weight will vary depending on final configuration

# HF1 Hydraulic Force Series™ Utility Winch Dimensions

## HF1 Dimensions with Local Controls

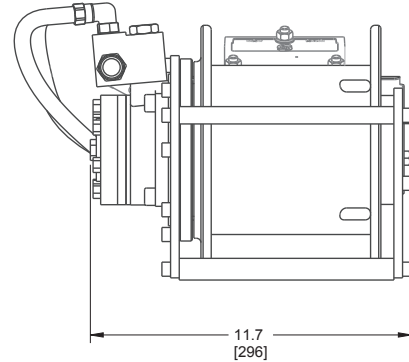
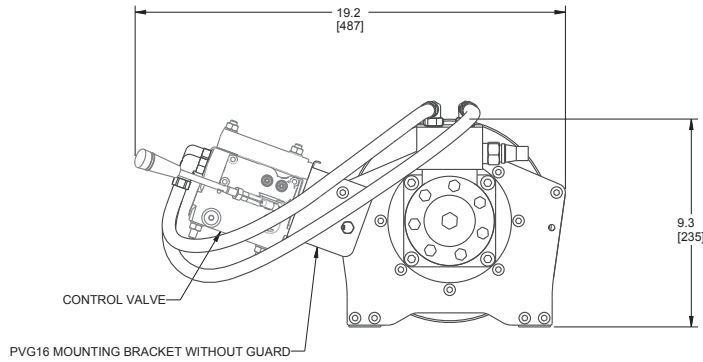

Mounting Controls without guard

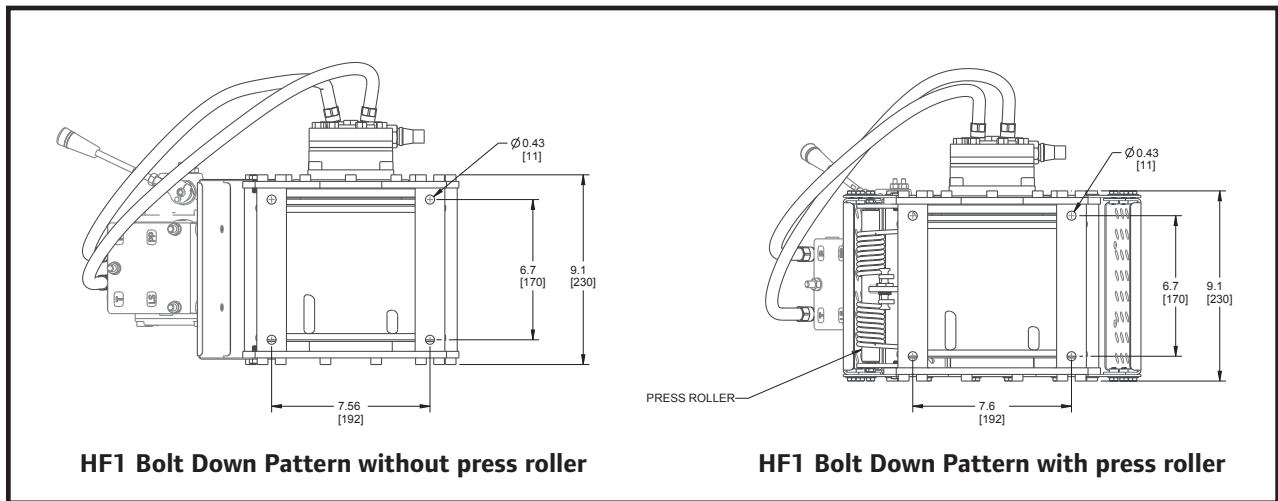

## HF1 Dimensions with Local Controls & Accessories

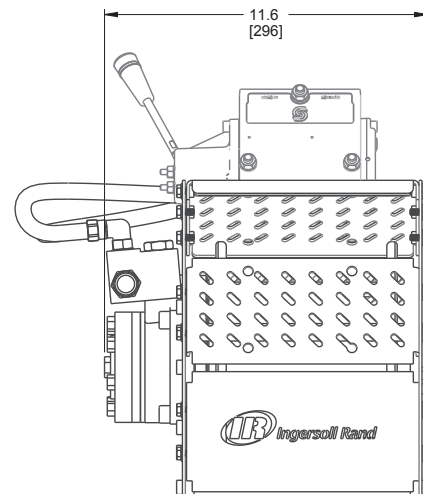
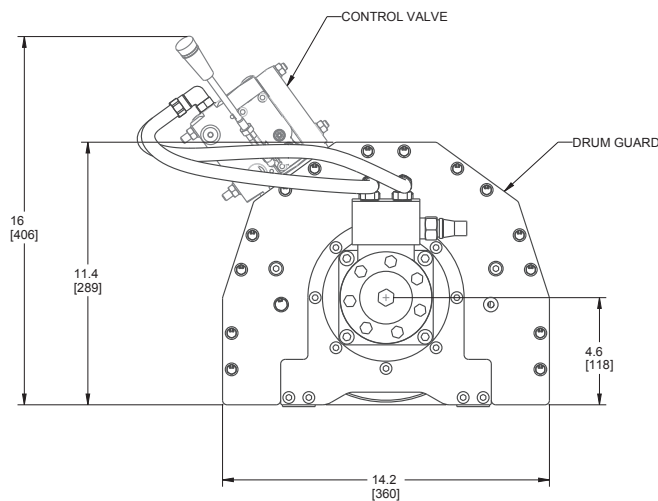

[ingersollrandproducts.com](http://ingersollrandproducts.com)

Ingersoll Rand (NYSE:IR) advances the quality of life by creating comfortable, sustainable and efficient environments. Our people and our family of brands—including Club Car®, Ingersoll Rand®, Thermo King® and Trane®—work together to enhance the quality and comfort of air in homes and buildings; transport and protect food and perishables; and increase industrial productivity and efficiency. We are a \$14 billion global business committed to a world of sustainable progress and enduring results. For more information, visit [ingersollrandproducts.com/hydraulicforce](http://ingersollrandproducts.com/hydraulicforce).